

## 攪拌機 Flange Mount Mixer

- 1/20HP 攪拌機可直接安裝於 PULSAFEEDER 35 加崙及 55 加崙桶。
- 馬達(Motor)有 1/3HP,115V,OPEN 、1/20HP,115V,TEFC 、1/20HP,230V,TEFC 。
- 攪拌軸為 316 SS,可選防腐蝕塗佈在攪拌軸及攪拌葉上。

安裝尺寸圖

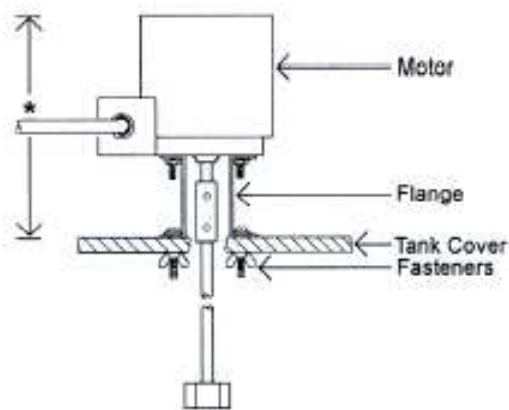

\* Height varies with mixer configuration.  
Maximum height is 12"

Mounting Dimensions:

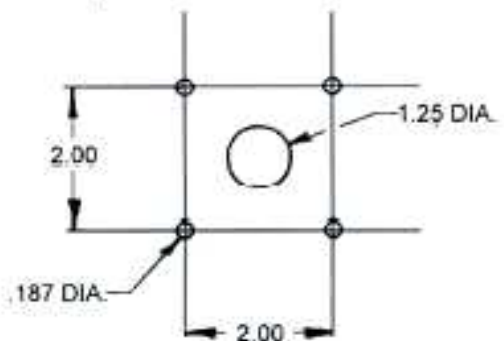

### 【規格說明】

Horsepower	1/3 HP	1/20HP	
RPM	1725 RPM	1500 RPM	
Type	Open Drip Proof	Totally Enclosed Fan Cooled	
Voltage	115V	115V	230V
Amperage	5.9A	1.9A	0.75A
Motor Design	- split phase - sleeve bearings	- split phase - ball bearings - non ventilated	
*Shaft Length Diameter	34"x 1/2"	28"x 5/16"	
Impeller Diameter	2 1/2"	1 1/4"	

\*Shafts may be cut to length upon request

瑞順企業股份有限公司

台北市中正區重慶南路一段 121 號 4 樓之 9

TEL : 02-2331-1097

FAX : 02-2331-9629